

REVISIONS			
REV.	DESCRIPTION	DATE	BY
A	Initial	10/20/2016	DF
B	Coating Note	9/20/2019	DF

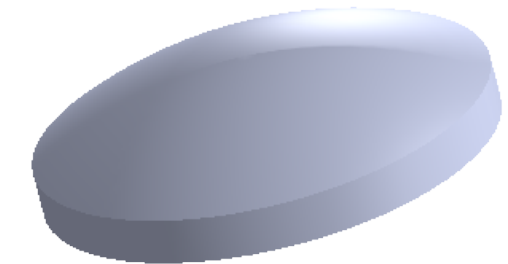

S1 Aspheric Surface

Radius: 46.350217 mm (4 fringes power)
 Irregularity: <math>< 0.5 \mu\text{m}</math> PV
 Surface Quality: 40-20 S-D

S2 Plano Surface

Radius: Plano
 Flatness: $\lambda/4$ (<math>< 1</math> fringe power)
 Surface Quality: 40-20 S-D

EFL 100.74mm @ $\lambda = 546\text{nm}$

Notes

Material: UV Grade Fused Silica
 Centration: <math>< 3</math> arcmin
 Custom Coating per Customer Request
 Clear Aperture: 45mm
 Break all Sharp Edges

1208 Sigma CT.
 Rockwall, TX 75087
 Ph: (972) 722-1064
 Web: www.archeroptx.com



PROPRIETARY AND CONFIDENTIAL
 THE INFORMATION CONTAINED IN THIS DRAWING IS THE SOLE PROPERTY OF ARCHER OPTX, INC. ANY REPRODUCTION IN PART OR AS A WHOLE WITHOUT THE WRITTEN PERMISSION OF ARCHER OPTX, INC. IS PROHIBITED.

		UNLESS OTHERWISE SPECIFIED:	NAME	DATE	TITLE: Asphere - Plano Lens
		DIMENSIONS ARE IN MM	DRAWN		
		TOLERANCES:	CHECKED		
		FRACTIONAL \pm	ENG APPR.		
		ANGULAR: MACH \pm BEND \pm	MFG APPR.		
		TWO PLACE DECIMAL \pm	Q.A.		SIZE DWG. NO. REV B GACP-50-100 B
		THREE PLACE DECIMAL \pm	COMMENTS:		
		INTERPRET GEOMETRIC TOLERANCING PER:			SCALE: 1.25: WEIGHT: SHEET 1 OF 1
		MATERIAL			
NEXT ASSY	USED ON	FINISH			
APPLICATION		DO NOT SCALE DRAWING			